



INSTALLATION INSTRUCTIONS

SR-M SERIES PRO



***THESE INSTRUCTIONS ARE FOR THE FOLLOWING LIGHTS:
SR-M SERIES PRO**

IMPORTANT

THANK YOU FOR PURCHASING RIGID PRODUCTS FOR YOUR VEHICLE.
Please read through all of these Instructions and tips before proceeding with the installation.
We do our best to provide a simple installation process for all applications however
a professional installation is always recommended.

**Always disconnect any power sources connected to your vehicle
before servicing fuses or electrical systems.**

SR-M SERIES PRO

Assemble your LED light kit by attaching the mount (D) to the housing (A) using the provided bolt(s) (B) and nylon lock nut(s) (C). Tighten until snug. Use the remaining bolt, washers, and nut (E, F, G, H) to mount the completed light assembly. A 5/16" hole is required. (See Figure Below)



WIRING INSTRUCTIONS

IMPORTANT

Always disconnect the vehicle battery terminals before servicing the electrical system



1. When routing wire harness through any metal surface be sure it is free of any sharp edges and protected using wire sheathing or a grommet.
2. Route the harness through vehicle, connect the SR-M lamps by directly plugging into the Deutsch connector's that are pre-terminated onto the harness.
3. Route the switch lead of the harness to the desired switch location and follow the wiring diagram to ensure proper connections at the switch.
4. Connect the positive and negative battery terminals once all connections have been made with the RED harness lead connected to the positive battery terminal and the BLACK wire to the negative battery terminal.
5. Test to verify functionality, be sure to properly aim your new SR-M lighting before final torque on all mounting hardware.
6. If connecting to an existing switch be aware of the current rating of your selected switch, if switch rating is less than the amperage required to power your lighting then a relay must be added in line to prevent failure of the switch.
7. If connecting to existing wiring, make sure to use appropriate fusing and wire gauge. Be sure to use heat shrink tubing on all connections to ensure a weather tight seal.

SWITCH WIRING

NOTE: **GOLD** Spade is the Top of Switch, 3/4" mounting hole required

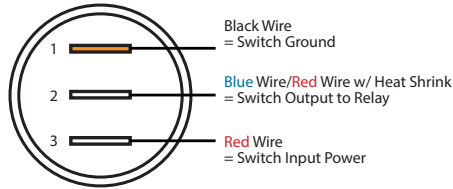

SWITCH WIRING (SINGLE AND SETS)

- P1- Black Wire
= Switch Ground
- P2 - Blue Wire/Red Wire w/ Heat Shrink
= Switch Output to Relay
- P3 - Red Wire
= Switch Input Power

**Wiring: Wire your lights according to the instructions included with the light.
Take care to avoid any heat sources and sharp or abrasive surfaces.**

SR-M MOUNTING TEMPLATE

Measurements are in Inches

WHEN PRINTING:
PRINT 100% ACTUAL SIZE
DO NOT SIZE TO FIT

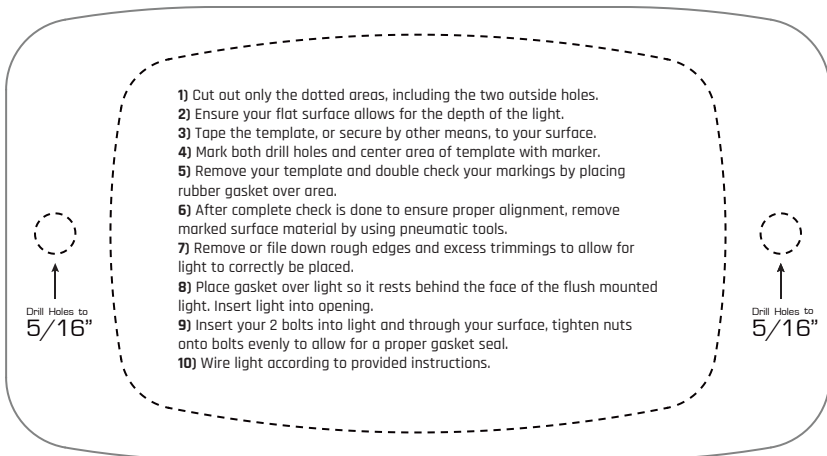



**Your installation is now complete.
Welcome to the Rigid Nation!**

WARRANTY INFORMATION

For warranty information, visit www.rigidindustries.com/about/warranty

779 N Colorado St, Gilbert, AZ 85233 • 855-760-5337
www.rigidindustries.com

SR-M and Rigid Industries are registered and/or common law marks owned by JST Performance, LLC,
a Delaware limited liability company d/b/a Rigid Industries.

11-12914-A